

Project 17: Site Location Plan - scale 1:1250

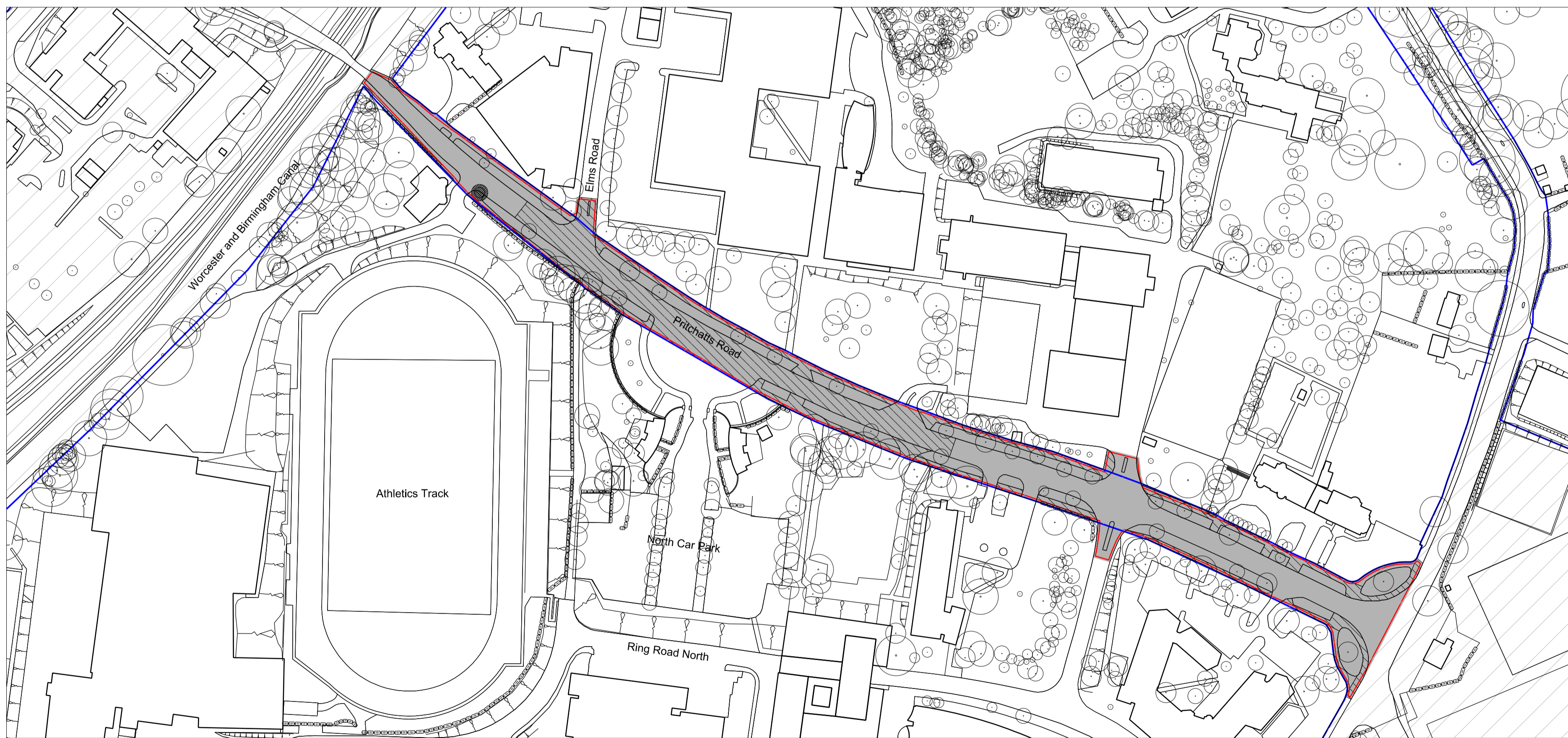

Project 17: Demolitions Block Plan - scale 1:1250



KEY

- Planning Application Site Boundary
- University of Birmingham Land Ownership Boundary
- Trees to be lost (1 tree lost)
- Existing surface to be removed
- Area covered by works

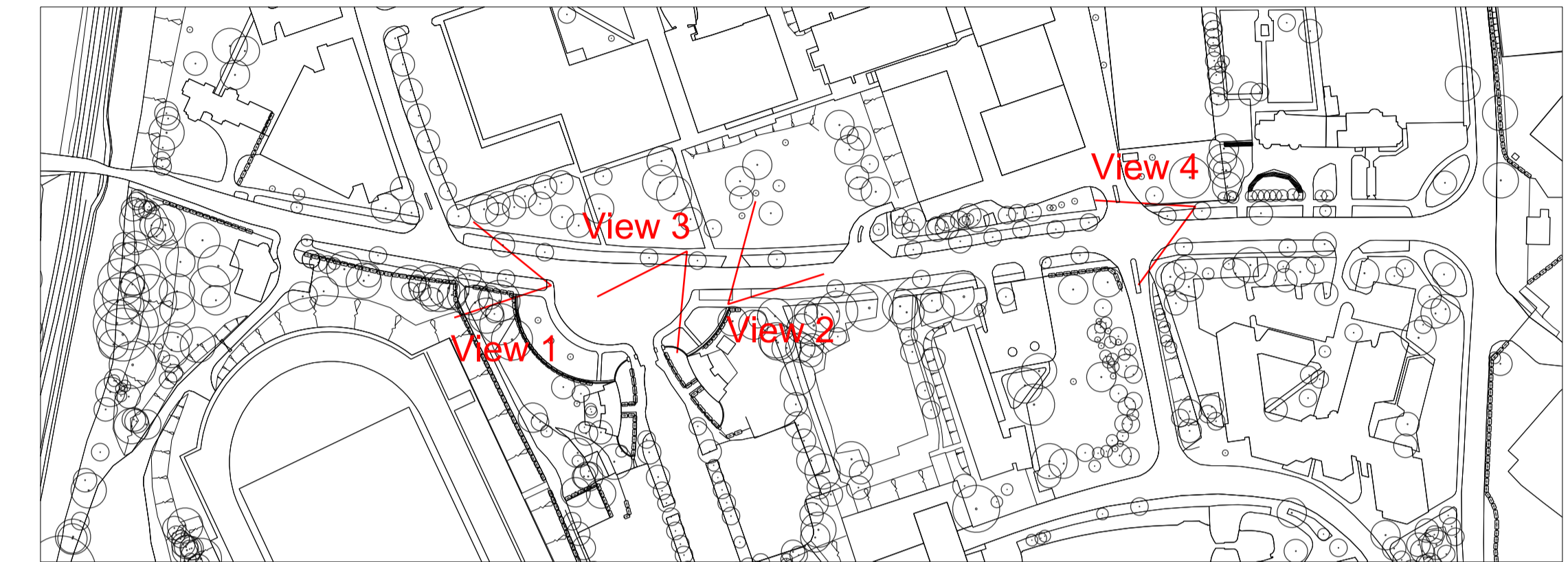

VIEWS KEY



View 1



View 2



View 3



View 4

Project 17: Photographs of existing

Rev	Date	Description	By	Chk	App
-	02.03.2012	PLANNING ISSUE	TF	LP	LP
A	09.03.2012	RE- ISSUED FOR PLANNING	TF	LP	LP

Rev	Date	Description	By	Chk	App

GENERAL NOTES

DO NOT SCALE DRAWINGS. USE FIGURED DIMENSIONS ONLY.  
 ALL DIMENSIONS TO BE CHECKED ON SITE. DISCREPANCIES TO BE REPORTED IMMEDIATELY TO THE ARCHITECT  
 FOR STRUCTURAL DIMENSIONS AND SETTING OUT SEE STRUCTURAL ENGINEERS DRAWINGS

ALL INFORMATION SUBJECT TO STATUTORY APPROVALS BEING OBTAINED  
 INFORMATION NOT TO BE USED OTHER THAN AS DEFINED BY THE DRAWING STATUS

Edbaston Central Campus Development Drawing No. 0504 - A HA- 17 - 100 A  
 Hybrid Planning Application Scale 1:1250 @ A1  
 Project 17: Pritchatts Road Improvements File Name N/A  
 Existing, Demolitions Date 01/02/2012  
 9 HENEAGE STREET, SPITALFIELDS, LONDON, E1 5LJ  
NOTE: DO NOT SCALE DRAWINGS. ALL DIMENSIONS TO BE CHECKED ON SITE. ERRORS TO BE REPORTED IMMEDIATELY TO THE ARCHITECT



PHOTOGRAPHS BY GUY AARON/GETTY IMAGES AND JONAS BLOM/ISTOCK