

Area between Metallurgy and Materials Building and Data Centre to be designed with appearance of a public space (rather than a service road)

New pedestrian/ cycle path connecting Route to the Vale to Elms Rd

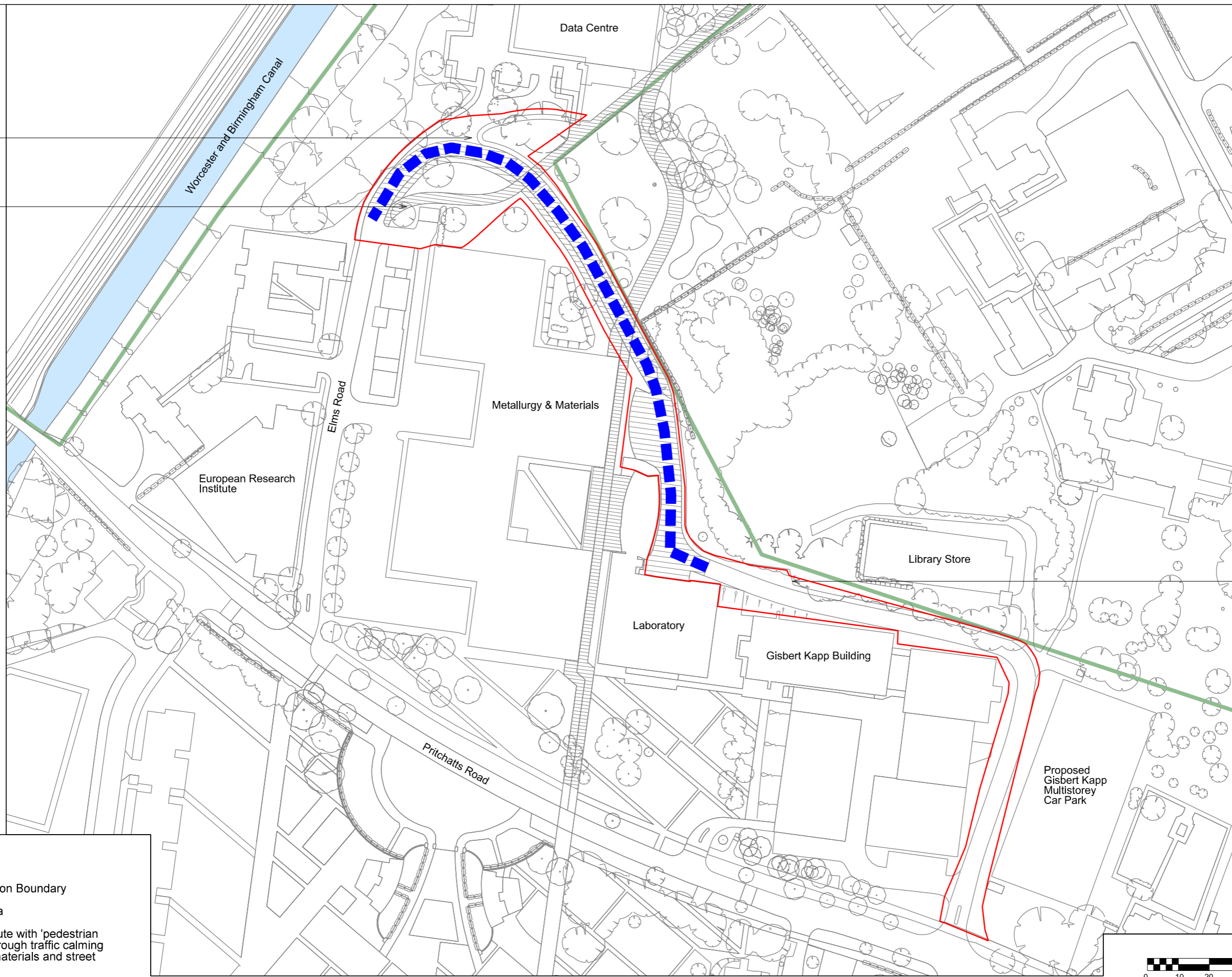

Adjustments to existing retaining wall to minimise impact on existing trees

Min 4 new trees to be planted

**KEY**

- Planning Application Boundary
- Conservation Area
- - - Section of new route with 'pedestrian friendly' design through traffic calming and selection of materials and street furniture

Rev	Date	Description	By	Chk	App
-	02.03.2012	PLANNING ISSUE	TF	LP	LP
A	09.03.2012	RE-ISSUED FOR PLANNING	TF	LP	LP

Rev	Date	Description	By	Chk	App

**GENERAL NOTES**

DO NOT SCALE DRAWINGS, USE FIGURED DIMENSIONS ONLY.

ALL DIMENSIONS TO BE CHECKED ON SITE DISCREPANCIES TO BE REPORTED IMMEDIATELY TO THE ARCHITECT

FOR STRUCTURAL DIMENSIONS AND SETTING OUT SEE STRUCTURAL ENGINEERS DRAWINGS

ALL INFORMATION SUBJECT TO STATUTORY APPROVALS BEING OBTAINED

INFORMATION NOT TO BE USED OTHER THAN AS DEFINED BY THE DRAWING STATUS

**Edbaston Central Campus Development** Drawing No. 0504-A-HA-18-300-A

**Hybrid Planning Application** Scale: 1:1250 @ A3

**Project 18: Access Road Behind Gisbert Kapp - Parameters Plan** File Name: N/A

Date: 02/02/2012

9 HENEAGE STREET, SPITALFIELDS, LONDON, E1 5LJ

NOTE: DO NOT SCALE DRAWINGS. ALL DIMENSIONS TO BE CHECKED ON SITE. ERRORS TO BE REPORTED IMMEDIATELY TO THE ARCHITECT

